

DATE	DESCRIPTION

**Civil Engineering**  
Transportation, CEI &  
Landscape Architecture  
C.A. # 30209  
L.C. # 2800584  
© 2013

# SITE LAYOUT PLAN

STARBUCKS  
125 E GRANADA BOULEVARD  
ORMOND BEACH, FLORIDA 32176

THE DRAWING IS THE PROPERTY OF HARRY NEWKIRK P.E. #62971. IT IS TO BE USED ONLY FOR THE PROJECT AND NOT TO BE REPRODUCED OR TRANSMITTED IN ANY FORM OR BY ANY MEANS, ELECTRONIC OR MECHANICAL, WITHOUT THE WRITTEN PERMISSION OF HARRY NEWKIRK P.E. #62971. HARRY NEWKIRK P.E. #62971

PROJECT No.: 2017-183  
DATE: MARCH 2018  
DESIGN BY: HHN  
DRAWN BY: DAB  
CHECKED BY: HHN  
SCALE: 1" = 20'  
DRAWING NUMBER:

6

- GENERAL NOTES:**
- CITY OF ORMOND BEACH BUILDING PERMITS ARE REQUIRED FOR BUILDING DUMPSTER ENCLOSURE, LIGHT POLES, SCREEN ENCLOSURE. CONTRACTOR SHALL BE RESPONSIBLE FOR SUBMITTING APPROPRIATE INFORMATION (ENGINEERING, SPECIFICATIONS, SHOP DRAWINGS, ETC.).
  - ALL DIMENSIONS AND TIES ARE TO THE EDGE OF PAVEMENT AND OUTSIDE FACE OF BUILDING.
  - ALL IMPROVEMENTS SHALL BE STAKED FOR CONSTRUCTION BY MEANS OF DIGITAL COORDINATES BY SURVEYOR UTILIZING GEODETIC TOTAL STATION OR GPS. SCALING OF DRAWINGS FOR PURPOSES OF STAKING ARE AT THE SURVEYOR'S RISK.
  - THE CONTRACTOR SHALL COORDINATE WITH THE EXISTING ADJACENT BUSINESSES TO ENSURE THERE IS NO DISRUPTION TO THEIR RESPECTIVE OPERATIONS.
  - THE CONTRACTOR AT ITS OWN DISCRETION SHALL MAINTAIN THE CONSTRUCTION SITE SECURE FROM TRESPASS.
  - SOD ALL DISTURBED AREAS IN RIGHT-OF-WAY WITH BAHIA SOD.
  - NO SITE LIGHT POLES. ALL SITE LIGHTING WILL BE LOCATED ON THE BUILDING WITH GLARE GUARDS.

- PAVEMENT MARKING NOTES:**
- PAINTED PAVEMENT MARKINGS SHALL BE APPLIED AFTER PAVEMENT SURFACE HAS CURED. SURFACE SHALL BE FREE OF FINE SAND AND DEBRIS PRIOR TO APPLICATIONS.
  - APPLY PAINTED PAVEMENT MARKINGS AT LAST STAGE OF CONSTRUCTION AFTER LANDSCAPE PLANTINGS ARE INSTALLED.
  - PAIN SHALL BE SHERWIN WILLIAMS LOW-VOC ACRYLIC PRO PARK PAINT. APPLY PER MANUFACTURER'S RECOMMENDATIONS. REFER TO DRAWINGS FOR LOCATIONS OF SPECIFIC COLORS.
  - ALL REFLECTIVE PAVEMENT MARKERS ARE TO BE PLACED IN ACCORDANCE WITH FOOT STANDARD INDEX NO. 17352.
  - ALL SIGNS SHALL BE PLACED IN ACCORDANCE WITH INDEX NO. 17391 AND THE "MANUAL ON UNIFORM TRAFFIC CONTROL DEVICES FOR STREETS AND HIGHWAYS".
  - LOCATION OF SIGNS IS APPROXIMATE ONLY AND IS SUBJECT TO CHANGE AS DIRECTED BY THE ENGINEER.
  - FOR ADDITIONAL DETAILS SEE INDEX NO. 11689, 17302, 17344 AND 17346.
  - ALL TRAFFIC CONTROL SIGNS SHALL BE FABRICATED USING 3M BRAND "SCOTCHLITE" SHEETING (ENGINEER GRADE) ON MINIMUM .08 GA ALUMINUM BLANKS. ALL 36"x48" SIGNS SHALL BE .100 GA MINIMUM AND SHALL BE INSTALLED USING 3"x12" ROUND ALUMINUM POST. ALL STOP SIGNS SHALL BE 36" OCTAGON INSTALLED ON 12.3 LBS/FT "U" CHANNEL POST RAIL STEEL ONLY OR 3"x12" ROUND ALUMINUM POSTS. "U" CHANNEL POSTS MAY BE USED FOR SIGNS SMALLER THAN 36"x36". ALL SPEED LIMIT SIGNS SHALL BE 24"x30".

- MAINTENANCE OF TRAFFIC NOTES:**
- THE GENERAL CONTRACTOR SHALL PROVIDE A TRAFFIC CONTROL PLAN TO ENGINEER OF RECORD AND CITY OF ORMOND BEACH PRIOR TO THE START OF CONSTRUCTION. THE TRAFFIC CONTROL PLAN SHALL BE APPROVED BY THE DESIGN ENGINEER.
  - THE CONTRACTOR SHALL NOTIFY OUTERBACK AND EAST SHOPPING CENTER TENANTS ONE (1) WEEK PRIOR TO CLOSING ANY DRIVEWAY AND PARKING SPACES WITHIN THE DEVELOPMENT.
  - CONTRACTOR SHALL PROVIDE WRITTEN NOTIFICATION TO THE BUSINESS AFFECTED BY CONSTRUCTION ACTIVITIES ONE (1) WEEK IN ADVANCE OF THE START OF ANY PHASE OF CONSTRUCTION.
  - OUTBACK AND EAST SHOPPING CENTER MAIN ACCESS DRIVEWAYS MUST BE OPEN AT ALL TIMES THROUGH OUT CONSTRUCTION.
  - ANY CHANGES TO THE TRAFFIC CONTROL PLAN SHALL BE APPROVED BY THE DESIGN ENGINEER.

- PAVING LEGEND**
- ASPHALT PAVEMENT: 1.5" SP-3.5 (TL-C) WITH TACK COAT PER FOOT SPECIFICATIONS (2 LIFTS); 6" CRUSHED CONCRETE (LBR=100) MIN OF 98% MODIFIED PROCTOR; MAX DENSITY PER AASHTO T-188 (4" MAX. LIFTS); 1.2" STABILIZED SUBBASE (LBR 40) MIN OF 98% MODIFIED PROCTOR; MAX DENSITY PER AASHTO T-188 (TYPE B STABILIZATION)
  - MILL AND OVERLAY: MILL AND OVERLAY WITH 1" SP-3.5 WITH TACK COAT PER FOOT SPECIFICATIONS
  - CONCRETE PAVEMENT: 6" CONCRETE (3,000 P.S.I. @ 28 DAYS) APPROVED FOOT MIX DESIGN; 1.2" STABILIZED SUBGRADE (LBR 40) MIN OF 98% MODIFIED PROCTOR; MAX DENSITY PER ASTM D1557, AASHTO T-188 (6" LIFTS) CONTROL JOINT SPACING PER FOOT INDEX 305; NOTE: ADD BLACKTINT TO DRIVE-THRU PAVEMENT AREA.
  - CONCRETE SIDEWALK: 4" THICK CONCRETE (MIN.) 3,000 PSI CONCRETE PER FOOT INDEX NO. 310; SEE CITY DETAIL NO. 3; SHEET NO. 15 AND SIDEWALK DETAIL, SHEET NO. 13

- LEGEND**
- TYPE 'D' CURB: TRANSITION LOCATION FROM TYPE 'D' CURB TO FLUSH
  - SITE LIGHTING, SINGLE FIXTURE (SEE DETAIL, SHEET No. 14)

- DRIVE THRU KEY:**
- VEHICLE HEIGHT DETECTOR (8'-6" CLEARANCE)
  - PRE-SELL MENU BOARD
  - DRIVE THRU CANOPY AND SPEAKER
  - DRIVE THRU ORDER MENU BOARD

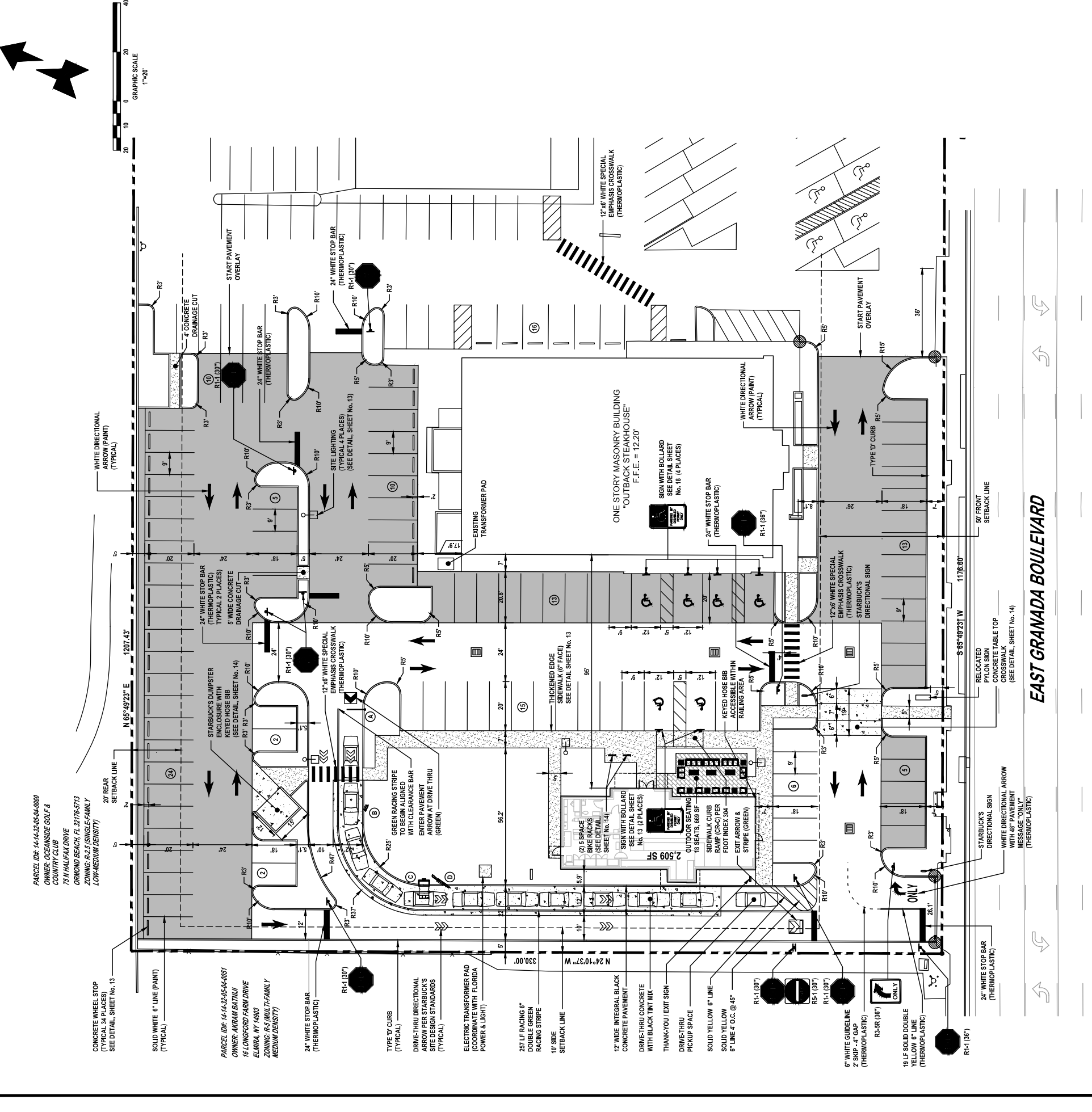

EAST GRANADA BOULEVARD